

DATE: 7-6-12
INSPECTED BY: MARTY CROSSLAND
INVESTIGATION OF ILLEGAL DOWNSPOUT
CONNECTIONS AT 903 HALEY AVENUE.
ALL DOWNSPOUTS OUTLET ON THE
GROUND SURFACE AND ARE NOT
IN VIPLATION.

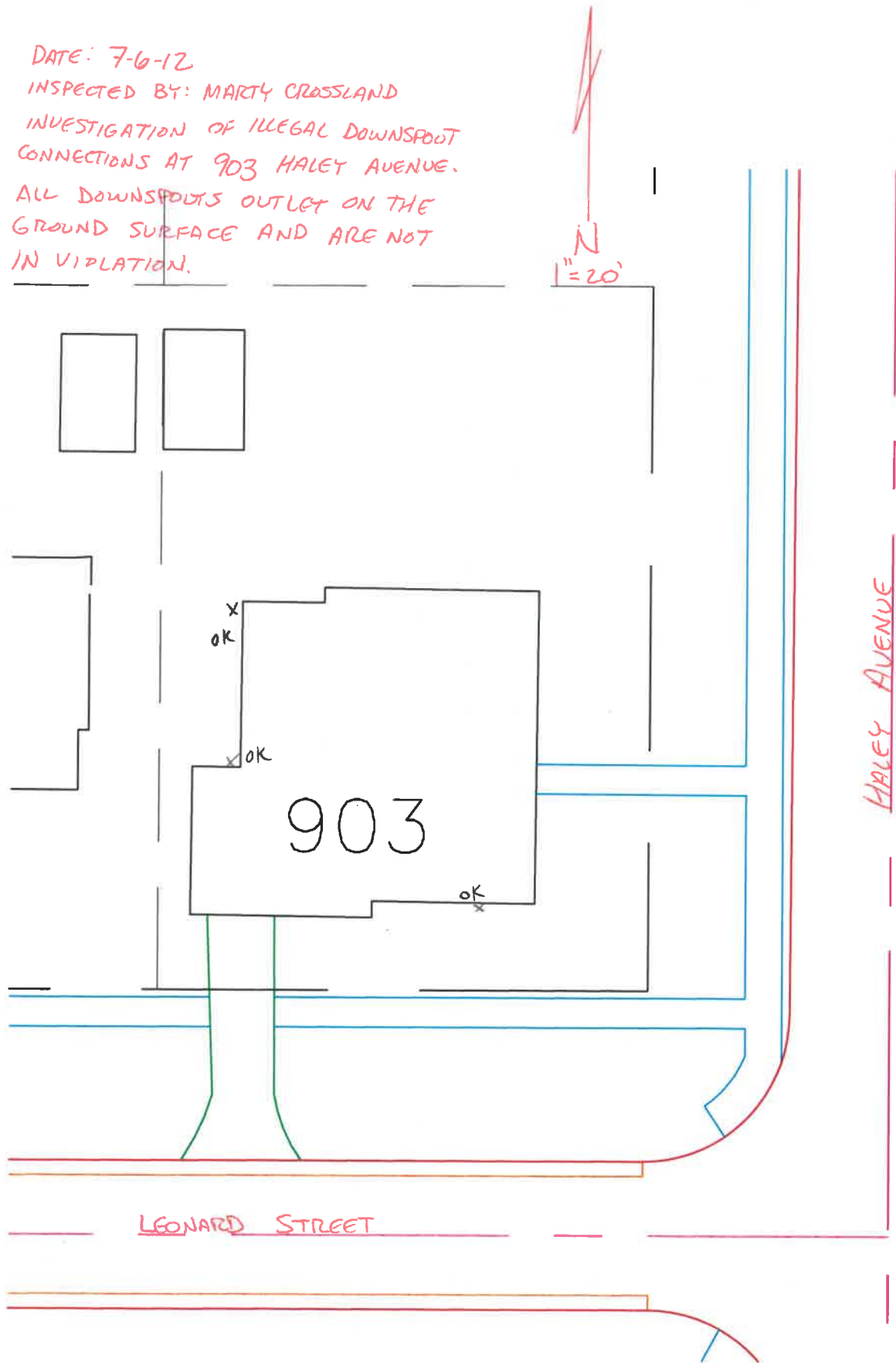

SCANNED